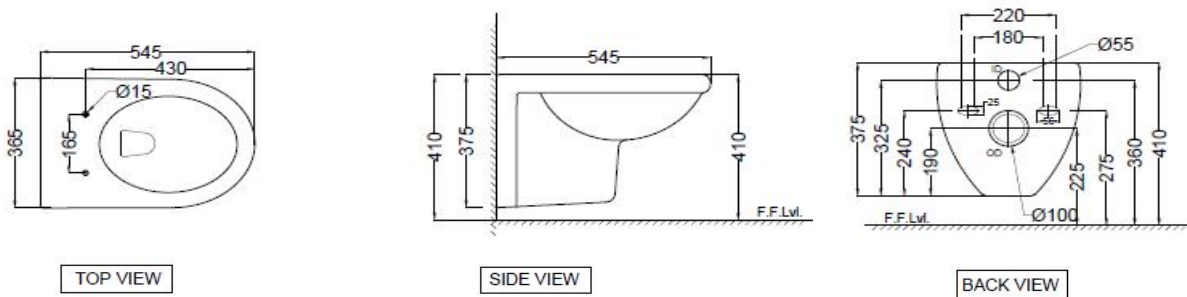

SPECIFICATION DATA SHEET
PRODUCT DETAILS

Manufacturer :	ESSCO	Type:	Wall Hung WC
Colour:	White	Flush valves	Regular, Dual & I Flush advantages
Outlet	Horizontal	Material:	Ceramic - Vitreous China
Technical Details:	Internal diameter of inlet hole dia. $\varnothing 55 \pm 3$ mm External diameter of outlet hole dia. $\varnothing 100 \pm 5$ mm		

PRODUCT IMAGE

TECHNICAL DRAWING

Product Dimension	365x545x375 mm	FEATURES
Product Weight	15.38 kg	Complete Trap Glaze,Packed with Accessories,Dual Flushing - 3/6 LPF, Anti germ glaze.
ACCESSORIES INCLUDED		
PP soft close seat cover		CMS-WHT-101S
Inlet & Outlet gasket		ZPS-WHT-GK01
ACCESSORIES EXCLUDED		
Rag bolt		ZPS-SNS-RB01 & ZPS-MST-RB02
Concealed cistern model no		JCS-WHT-2400S,2400FS,2400WS

CERTIFICATION

All technical dimensions are in accordance to Bureau of Indian Standards

DISCLAIMER: Our every effort has been made to ensure factual accuracy, the information presented subject to changes due to requirements in different sites, markets and/ or countries. All dimensions are in mm (Tolerance ± 5 MM). Jaquar reserves the right to make the necessary amendments at any time without prior notice.